

## Dynamic Back Interface

**Tools needed:** 3/16 Hex Key, 7/16 Socket

**Precautions:** Wheelchair will not fold once the Dynamic Back is installed. Make sure that the wheelchair anti-tippers are in place and adjusted. To ensure safety, completely tighten the socket head cap screws on all mounting and assembly collars.

**Type of chair:** Most folding chairs and rigid frame chairs. (Look at area of frame where mounting collars will be placed, then check for clearance.)

**Prep the chair:** Remove all upholstery. Remove or cut off back push canes or uprights. (Sometimes the uprights / Back canes will need to be cut. Leave a minimum of 6" measurement from the top horizontal - side frame of chair. You may also need to make an adjustment cut to the uprights according to the placement of the lower back insert. Do this as one of the last steps of assembly.)

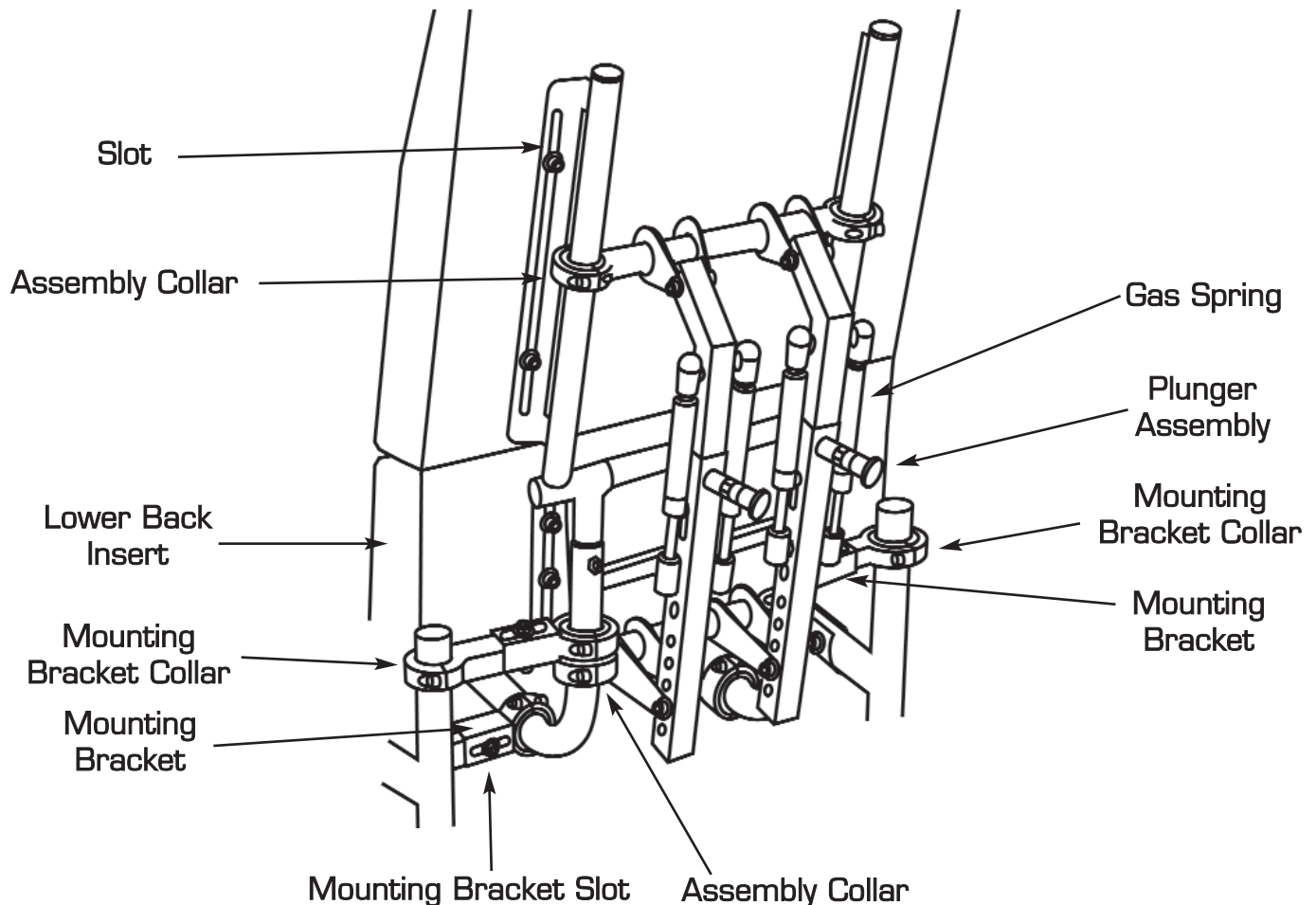

## Dynamic Back Interface



**Installing the Dynamic Back:** *Note: There should little or no need to adjust the assembly collars on the Dynamic Back before the unit is mounted.*

- 1) Loosen (on the Dynamic Frame side) / Remove (on the chair frame side) all mounting collars. Also, loosen the bolt in the adjustable slot of the mounting brackets so both side move freely.
- 2) Attach lower mounting brackets and tighten up the socket head cap screws on all collars. Attach collars as close to the front of the wheelchair as possible without clamping on to the weld.
- 3) Attach upper mounting bracket and tighten up the hex bolts on all collars.
- 4) Adjust the position of the Dynamic Back left to right to achieve a mid-line position in wheelchair frame, at this time check and adjust seat to back angle. Then completely tighten all mounting bracket collar socket head cap screws. Then completely tighten up all mounting collar adjustable slot bolts.

**Prepping the back inserts:** With the Dynamic Back there must be a 2 piece back insert (set up similar to a bi-angular back)

- 1) Check for a minimum of a 1/2" clearance between the upper back insert and the lower back insert.
- 2) Position wood base of the lower back insert into position – trace slots from Dynamic Back onto WOOD. Place at least 2 t-nuts per slot.
- 3) Complete #2 (previous step) for upper back insert. Make sure there's a 1/2" gap between the two inserts.
- 4) Complete and mount inserts. (Finish system with Miller's Push Handles and Miller's 1" tubing plugs)